

ベアリングテクノロジー | すべり軸受 | イグリュールX

スリーブ型ベアリング (形状S)

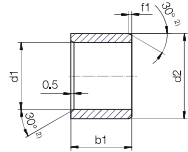

²⁾ 肉厚 < 0.6mm、面取り=20°

内径d1を面取り加工

d1 [mm]	Ø 1-6	Ø 6-12	Ø 12-30	Ø > 30
f1 [mm]	0.3	0.5	0.8	1.2

i ISO 3547-1に準拠した寸法および特殊寸法

i 注文例 **XSM-0203-03** - 最小注文数量なし
Xイグリュール材質 Sスリーブ型 Mメートル寸法 02内径d1 03外径d2 03全長b1

d1	d1 公差 ³⁾	d2	b1 h13	製品番号	d1	d1 公差 ³⁾	d2	b1 h13	製品番号
[mm]		[mm]	[mm]		[mm]		[mm]	[mm]	
2.0	+0.006	3.5	3.0	XSM-0203-03	12.0		14.0	3.5	XSM-1214-035
3.0	+0.046	4.5	3.0	XSM-0304-03	12.0		14.0	6.0	XSM-1214-06
3.0		4.5	6.0	XSM-0304-06	12.0		14.0	8.0	XSM-1214-08
4.0		5.5	4.0	XSM-0405-04	12.0		14.0	10.0	XSM-1214-10
4.0		5.5	6.0	XSM-0405-06	12.0		14.0	12.0	XSM-1214-12
4.0		5.5	9.0	XSM-0405-09	12.0		14.0	15.0	XSM-1214-15
4.0		5.5	10.0	XSM-0405-10	12.0		14.0	20.0	XSM-1214-20
5.0		7.0	3.5	XSM-0507-035	12.0		14.0	25.0	XSM-1214-25
5.0	+0.010	7.0	5.0	XSM-0507-05	13.0		15.0	10.0	XSM-1315-10
5.0	+0.058	7.0	8.0	XSM-0507-08	13.0		15.0	20.0	XSM-1315-20
5.0		7.0	10.0	XSM-0507-10	14.0		16.0	12.0	XSM-1416-12
6.0		8.0	6.0	XSM-0608-06	14.0		16.0	15.0	XSM-1416-15
6.0		8.0	8.0	XSM-0608-08	14.0		16.0	20.0	XSM-1416-20
6.0		8.0	10.0	XSM-0608-10	14.0		16.0	25.0	XSM-1416-25
6.0		8.0	13.8	XSM-0608-13	15.0	+0.016	17.0	7.0	XSM-1517-07
7.0		9.0	10.0	XSM-0709-10	15.0	+0.086	17.0	10.0	XSM-1517-10
7.0		9.0	12.0	XSM-0709-12	15.0		17.0	15.0	XSM-1517-15
8.0		10.0	6.0	XSM-0810-06	15.0		17.0	20.0	XSM-1517-20
8.0		10.0	8.0	XSM-0810-08	15.0		17.0	25.0	XSM-1517-25
8.0		10.0	10.0	XSM-0810-10	16.0		18.0	10.0	XSM-1618-10
8.0		10.0	12.0	XSM-0810-12	16.0		18.0	12.0	XSM-1618-12
8.0	+0.013	10.0	15.0	XSM-0810-15	16.0		18.0	15.0	XSM-1618-15
10.0	+0.071	12.0	3.5	XSM-1012-035	16.0		18.0	20.0	XSM-1618-20
10.0		12.0	6.0	XSM-1012-06	16.0		18.0	25.0	XSM-1618-25
10.0		12.0	8.0	XSM-1012-08	16.0		18.0	35.0	XSM-1618-35
10.0		12.0	10.0	XSM-1012-10	17.0		19.0	20.0	XSM-1719-20
10.0		12.0	12.0	XSM-1012-12	18.0		20.0	15.0	XSM-1820-15
10.0		12.0	15.0	XSM-1012-15	18.0		20.0	20.0	XSM-1820-20
10.0		12.0	20.0	XSM-1012-20	18.0		20.0	25.0	XSM-1820-25

³⁾ 圧入後、試験方法 61ページ

製品概要

d1	d1 公差 ³⁾	d2	b1 h13	製品番号	d1	d1 公差 ³⁾	d2	b1 h13	製品番号
[mm]		[mm]	[mm]		[mm]		[mm]	[mm]	
20.0	+0.016 +0.086	22.0	14.0	XSM-2022-140	30.0		34.0	20.0	XSM-3034-20
20.0		22.0	14.5	XSM-2022-145	30.0	+0.020	34.0	25.0	XSM-3034-25
20.0		22.0	17.0	XSM-2022-17	30.0	+0.104	34.0	30.0	XSM-3034-30
20.0		22.0	18.0	XSM-2022-18	30.0		34.0	40.0	XSM-3034-40
20.0		22.0	20.0	XSM-2022-20	32.0		36.0	20.0	XSM-3236-20
20.0		23.0	7.0	XSM-2023-07	32.0		36.0	25.0	XSM-3236-25
20.0		23.0	10.0	XSM-2023-10	32.0		36.0	30.0	XSM-3236-30
20.0		23.0	15.0	XSM-2023-15	32.0		36.0	35.0	XSM-3236-35
20.0		23.0	20.0	XSM-2023-20	32.0		36.0	40.0	XSM-3236-40
20.0		23.0	25.0	XSM-2023-25	32.0		36.0	54.0	XSM-3236-54
20.0		23.0	30.0	XSM-2023-30	35.0		39.0	20.0	XSM-3539-20
22.0		25.0	15.0	XSM-2225-15	35.0		39.0	30.0	XSM-3539-30
22.0		25.0	20.0	XSM-2225-20	35.0		39.0	40.0	XSM-3539-40
22.0		25.0	25.0	XSM-2225-25	35.0		39.0	50.0	XSM-3539-50
22.0		25.0	30.0	XSM-2225-30	40.0	+0.025	44.0	20.0	XSM-4044-20
24.0		26.0	20.0	XSM-2426-20	40.0	+0.125	44.0	30.0	XSM-4044-30
24.0		27.0	6.0	XSM-2427-06	40.0		44.0	40.0	XSM-4044-40
24.0		27.0	15.0	XSM-2427-15	40.0		44.0	50.0	XSM-4044-50
24.0		27.0	20.0	XSM-2427-20	45.0		50.0	20.0	XSM-4550-20
24.0	+0.020 +0.104	27.0	25.0	XSM-2427-25	45.0		50.0	30.0	XSM-4550-30
24.0		27.0	30.0	XSM-2427-30	45.0		50.0	50.0	XSM-4550-50
25.0		28.0	7.7	XSM-2528-077	50.0		55.0	20.0	XSM-5055-20
25.0		28.0	9.0	XSM-2528-09	50.0		55.0	30.0	XSM-5055-30
25.0		28.0	12.0	XSM-2528-12	50.0		55.0	40.0	XSM-5055-40
25.0		28.0	13.0	XSM-2528-13	50.0		55.0	50.0	XSM-5055-50
25.0		28.0	15.0	XSM-2528-15	50.0		55.0	60.0	XSM-5055-60
25.0		28.0	20.0	XSM-2528-20	55.0		60.0	50.0	XSM-5560-50
25.0		28.0	25.0	XSM-2528-25	60.0		65.0	45.0	XSM-6065-45
25.0		28.0	30.0	XSM-2528-30	60.0		65.0	60.0	XSM-6065-60
25.0		28.0	35.0	XSM-2528-35	65.0	+0.030	70.0	50.0	XSM-6570-50
26.0		28.0	10.0	XSM-2628-10	70.0	+0.150	75.0	70.0	XSM-7075-70
27.0		30.0	5.7	XSM-2730-05	75.0		80.0	60.0	XSM-7580-60
28.0		32.0	20.0	XSM-2832-20	80.0		85.0	100.0	XSM-8085-100
28.0		32.0	25.0	XSM-2832-25	90.0		95.0	100.0	XSM-9095-100
28.0		32.0	30.0	XSM-2832-30	100.0	+0.036	105.0	100.0	XSM-100105-100
28.0		32.0	69.0	XSM-2832-69	110.0	+0.176	115.0	100.0	XSM-110115-100
30.0		34.0	10.0	XSM-3034-10	120.0		125.0	100.0	XSM-120125-100
30.0		34.0	15.0	XSM-3034-15					

³⁾ 圧入後、試験方法 61ページ