

ベアリングテクノロジー | すべり軸受 | イグリデュールJ

フランジ型ベアリング(形状F)

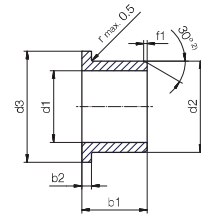

2) 肉厚 < 0.6 mm、面取り=20°

内径d1を面取り加工

d1 [mm]	∅ 1-6	∅ 6-12	∅ 12-30	∅ > 30
f1 [mm]	0.3	0.5	0.8	1.2

i ISO 3547-1に準拠した寸法および特殊寸法

i 注文例 JFM-0304-03 - 最小注文数量なし
Jイグリデュール材質 Fフランジ型 Mメートル寸法 03内径 d1 04外径d2 03全長b1

d1	d1	d2	d3	b1	b2	製品番号
[mm]	公差 ³⁾	[mm]	d13 ³⁾	h13	h13	
3.0	+0.014	4.5	7.5	3.0	0.75	JFM-0304-03
3.0	+0.054	4.5	7.5	4.5	0.75	JFM-0304-045
3.0	+0.020	4.5	7.5	5.0	0.75	JFM-0304-05
3.0	+0.080	6.0	9.0	10.0	1.50	JFM-0306-10
4.0		5.5	9.5	3.0	0.75	JFM-0405-03
4.0		5.5	9.5	6.0	0.75	JFM-0405-06
5.0		6.0	10.0	5.0	0.50	JFM-0506-05
5.0		7.0	11.0	3.0	1.00	JFM-0507-03
5.0	+0.020	7.0	11.0	5.0	1.00	JFM-0507-05
5.0	+0.068	8.0	12.0	4.0	1.00	JFM-0608-04
6.0		8.0	12.0	6.0	1.00	JFM-0608-06
6.0		8.0	12.0	8.0	1.00	JFM-0608-08
6.0		8.0	12.0	10.0	1.00	JFM-0608-10
6.0	+0.030	10.0	14.0	10.0	2.00	JFM-0610-10
6.0	+0.105	10.0	15.0	3.8	1.00	JFM-0810-038
8.0		10.0	15.0	5.0	1.00	JFM-0810-05
8.0		10.0	15.0	6.0	1.00	JFM-0810-06
8.0		10.0	15.0	7.0	1.00	JFM-0810-07
8.0		10.0	15.0	8.0	1.00	JFM-0810-08
8.0	+0.025	10.0	15.0	9.5	1.00	JFM-0810-09
8.0	+0.083	10.0	15.0	10.0	1.00	JFM-0810-10
8.0		10.0	15.0	10.0	1.00	JFM-0810125-10
8.0		10.0	14.0	10.0	1.00	JFM-081014-10
8.0		10.0	16.0	11.0	2.00	JFM-081016-11
8.0		10.0	12.0	16.0	1.00	JFM-081012-16

d1	d1	d2	d3	b1	b2	製品番号
[mm]	公差 ³⁾	[mm]	d13 ³⁾	h13	h13	
8.0	+0.025	12.0	16.0	6.0	2.00	JFM-0812-06
8.0	+0.115	12.0	16.0	9.0	2.00	JFM-0812-09
10.0		12.0	15.0	3.5	1.00	JFM-101215-035
10.0		12.0	18.0	5.0	1.00	JFM-1012-05
10.0		12.0	18.0	7.0	1.00	JFM-1012-07
10.0		12.0	18.0	9.0	1.00	JFM-1012-09
10.0	+0.025	12.0	18.0	10.0	1.00	JFM-1012-10
10.0	+0.083	12.0	18.0	12.0	1.00	JFM-1012-12
10.0		12.0	18.0	15.0	1.00	JFM-1012-15
10.0		12.0	18.0	17.0	1.00	JFM-1012-17
10.0		12.0	18.0	18.0	1.00	JFM-1012-18
10.0		14.0	17.5	14.0	1.00	JFM-1014-14
10.0	+0.040	16.0	22.0	10.0	3.00	JFM-1016-10
10.0	+0.130	16.0	22.0	16.0	3.00	JFM-1016-16
11.0		13.0	18.0	5.0	1.00	JFM-1113-05
12.0		14.0	20.0	4.0	1.00	JFM-1214-04
12.0		14.0	18.0	4.5	1.00	JFM-121418-045
12.0		14.0	20.0	5.0	1.00	JFM-1214-05
12.0	+0.032	14.0	20.0	7.0	1.00	JFM-1214-07
12.0	+0.102	14.0	20.0	9.0	1.00	JFM-1214-09
12.0		14.0	18.0	10.0	1.00	JFM-121418-10
12.0		14.0	20.0	12.0	1.00	JFM-1214-12
12.0		14.0	20.0	15.0	1.00	JFM-1214-15
12.0		14.0	20.0	17.0	1.00	JFM-1214-17
12.0	+0.050	18.0	24.0	8.0	3.00	JFM-1218-08
12.0	+0.160	18.0	24.0	12.0	3.00	JFM-1218-12

3) 圧入後、試験方法 61ページ

ベアリングテクノロジー | すべり軸受 | イグリデュールJ

d1	d1	d2	d3	b1	b2	製品番号
[mm]	公差 ³⁾	[mm]	d13 ³⁾	h13	h13	
12.0	+0.050	18.0	22.0	20.0	3.00	JFM-1218-20
12.0	+0.160	18.0	22.0	20.0	3.00	JFM-1218-20
14.0		16.0	22.0	3.0	1.00	JFM-1416-03
14.0		16.0	22.0	10.0	1.00	JFM-1416-10
14.0		16.0	22.0	12.0	1.00	JFM-1416-12
14.0		16.0	22.0	17.0	1.00	JFM-1416-17
14.0		18.0	22.0	20.0	2.00	JFM-141822-20
14.0	+0.032	18.0	25.0	24.0	2.00	JFM-141825-24
14.0	+0.102	17.0	23.0	4.0	1.00	JFM-1517-04
15.0		17.0	23.0	5.5	1.00	JFM-1517-055
15.0		17.0	23.0	9.0	1.00	JFM-1517-09
15.0		17.0	23.0	12.0	1.00	JFM-1517-12
15.0		17.0	23.0	17.0	1.00	JFM-1517-17
15.0	+0.050	21.0	27.0	20.0	3.00	JFM-1521-20
15.0	+0.160	21.0	27.0	20.0	3.00	JFM-1521-20
16.0		18.0	24.0	6.0	1.00	JFM-1618-06
16.0	+0.032	18.0	24.0	12.0	1.00	JFM-1618-12
16.0	+0.102	18.0	24.0	16.0	1.00	JFM-1618-16
16.0		18.0	24.0	17.0	1.00	JFM-1618-17
16.0	+0.050	22.0	28.0	12.0	3.00	JFM-1622-12
16.0	+0.160	22.0	28.0	15.0	3.00	JFM-1622-15
17.0		19.0	25.0	9.0	1.00	JFM-1719-09
17.0		19.0	25.0	21.0	1.00	JFM-1719-21
18.0		20.0	26.0	4.0	1.00	JFM-1820-04
18.0		20.0	26.0	12.0	1.00	JFM-1820-12
18.0	+0.032	20.0	26.0	17.0	1.00	JFM-1820-17
18.0	+0.102	20.0	26.0	22.0	1.00	JFM-1820-22
18.0		21.0	25.0	12.0	1.00	JFM-1821-12
19.0		22.0	26.0	23.0	1.00	JFM-1922-23
19.0		22.0	26.0	36.0	1.00	JFM-1922-36
20.0		23.0	30.0	11.5	1.50	JFM-2023-11
20.0	+0.040	23.0	30.0	15.5	1.50	JFM-2023-15.5
20.0	+0.124	23.0	30.0	16.5	1.50	JFM-2023-16
20.0		23.0	30.0	21.5	1.50	JFM-2023-21
20.0		26.0	32.0	15.0	3.00	JFM-2026-15
20.0	+0.065	26.0	32.0	20.0	3.00	JFM-2026-20
20.0	+0.195	26.0	32.0	25.0	3.00	JFM-2026-25
22.0	+0.040	25.0	32.0	8.0	1.50	JFM-222532-08
24.0	+0.124	30.0	36.0	30.0	3.00	JFM-2430-30

3) 圧入後、試験方法 61ページ

d1	d1	d2	d3	b1	b2	製品番号
[mm]	公差 ³⁾	[mm]	d13 ³⁾	h13	h13	
25.0		28.0	39.0	5.0	1.50	JFM-252839-05
25.0		28.0	35.0	6.0	1.50	JFM-2528-06
25.0		28.0	39.0	7.5	1.50	JFM-252839-075
25.0	+0.040	28.0	35.0	11.5	1.50	JFM-2528-11
25.0	+0.124	28.0	35.0	12.0	1.50	JFM-2528-12
25.0		28.0	35.0	14.5	1.50	JFM-2528-14.5
25.0		28.0	35.0	21.5	1.50	JFM-2528-21
25.0		32.0	38.0	20.0	4.00	JFM-2532-20
25.0	+0.065	32.0	38.0	25.0	4.00	JFM-2532-25
25.0	+0.195	32.0	35.0	7.0	2.00	JFM-283235-07
28.0		32.0	39.0	20.0	2.00	JFM-283239-20
30.0		32.0	40.0	12.0	1.00	JFM-303240-12
30.0	+0.040	34.0	42.0	16.0	2.00	JFM-3034-16
30.0	+0.124	34.0	42.0	20.0	2.00	JFM-3034-20
30.0		34.0	42.0	26.0	2.00	JFM-3034-26
30.0	+0.080	38.0	44.0	20.0	4.00	JFM-3038-20
30.0	+0.240	38.0	44.0	20.0	4.00	JFM-3038-20
30.0	+0.065	38.0	44.0	30.0	4.00	JFM-3038-30
30.0	+0.195	38.0	44.0	36.0	4.00	JFM-3038-36
35.0		39.0	47.0	12.0	2.00	JFM-3539-12
35.0		39.0	47.0	16.0	2.00	JFM-3539-16
35.0		39.0	47.0	26.0	2.00	JFM-3539-26
40.0		44.0	52.0	20.0	2.00	JFM-4044-20
40.0		44.0	52.0	30.0	2.00	JFM-4044-30
40.0	+0.050	44.0	52.0	40.0	2.00	JFM-4044-40
40.0	+0.150	44.0	52.0	40.0	2.00	JFM-4044-40
45.0		50.0	58.0	12.0	2.00	JFM-4550-12
45.0		50.0	58.0	20.0	2.00	JFM-4550-20
45.0		50.0	58.0	50.0	2.00	JFM-4550-50
50.0		55.0	63.0	11.5	2.00	JFM-5055-11.5
50.0		55.0	63.0	50.0	2.00	JFM-5055-50
55.0		60.0	68.0	50.0	2.00	JFM-5560-50
60.0		65.0	73.0	37.0	2.00	JFM-6065-37
60.0	+0.060	65.0	73.0	50.0	2.00	JFM-6065-50
60.0	+0.180	70.0	78.0	60.0	2.00	JFM-6570-60
70.0		75.0	83.0	50.0	2.00	JFM-7075-50
90.0		95.0	103.0	100.0	2.50	JFM-9095-100
100.0	+0.072	105.0	113.0	100.0	2.50	JFM-100105-100
110.0	+0.212	115.0	123.0	100.0	2.50	JFM-110115-100
120.0		125.0	133.0	100.0	2.50	JFM-120125-100