

ベアリングテクノロジー | すべり軸受 | イグリュールG

フランジ型ベアリング(形状F)

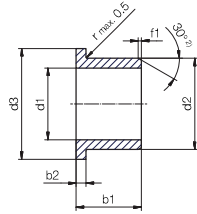

2) 肉厚 < 0.6mm、面取り=20°

内径d1を面取り加工

d1 [mm]	∅ 1-6	∅ 6-12	∅ 12-30	∅ > 30
f1 [mm]	0.3	0.5	0.8	1.2

ISO 3547-1に準拠した寸法および特殊寸法

注文例 **GFM-0304-02** - 最小注文数量なし
Gイグリュール材質 Fフランジ型 Mメートル寸法 03内径d1 04外径d2 02全長b1

d1	d1	d2	d3	b1	b2	製品番号
[mm]	公差 ³⁾	[mm]	[mm]	[mm]	[mm]	
3.0		4.5	7.5	2.0	0.50	GFM-0304-02
3.0	+0.014	4.5	7.5	2.7	0.75	GFM-0304-0275
3.0	+0.054	4.5	7.5	3.0	0.75	GFM-0304-03
3.0		4.5	7.5	5.0	0.75	GFM-0304-05
3.0		4.5	7.0	5.0	0.75	GFM-030407-05
4.0	+0.010	5.0	9.5	4.0	0.50	GFM-04050-04
4.0	+0.040	5.0	9.5	6.0	0.50	GFM-04050-06
4.0		5.5	9.5	2.5	0.75	GFM-0405-0255
4.0	+0.020	5.5	9.5	3.0	0.75	GFM-0405-03
4.0	+0.068	5.5	9.5	4.0	0.75	GFM-0405-04
4.0		5.5	9.5	6.0	0.75	GFM-0405-06
4.0		5.5	8.0	10.0	1.00	GFM-040508-10
5.0		6.0	10.0	3.5	0.50	GFM-0506-035
5.0	+0.010	6.0	10.0	4.0	0.50	GFM-0506-04
5.0	+0.040	6.0	10.0	5.0	0.50	GFM-0506-05
5.0		6.0	10.0	6.0	0.50	GFM-0506-06
5.0		6.0	10.0	15.3	0.50	GFM-0506-15
5.0		7.0	11.0	3.5	1.00	GFM-0507-03
5.0		7.0	11.0	4.0	1.00	GFM-0507-04
5.0		7.0	15.0	4.0	1.00	GFM-050715-04
5.0	+0.020	7.0	11.0	5.0	1.00	GFM-0507-05
5.0	+0.068	7.0	9.5	5.0	1.00	GFM-050709-05
5.0		7.0	11.0	7.0	1.00	GFM-0507-07
5.0		7.0	11.0	11.0	1.00	GFM-0507-11
5.0		7.0	11.0	14.5	1.00	GFM-0507-145
5.0		7.0	11.0	30.0	1.00	GFM-0507-30
6.0	+0.010	7.0	11.0	2.4	0.50	GFM-0607-024
6.0	+0.040	7.0	11.0	4.5	0.50	GFM-0607-045

d1	d1	d2	d3	b1	b2	製品番号
[mm]	公差 ³⁾	[mm]	[mm]	[mm]	[mm]	
6.0	+0.010	7.0	11.0	6.0	0.50	GFM-0607-06
6.0	+0.040	7.0	11.0	10.0	0.50	GFM-0607-10
6.0		8.0	12.0	2.5	1.00	GFM-0608-025
6.0		8.0	14.0	2.8	1.00	GFM-060814-028
6.0		8.0	12.0	4.0	1.00	GFM-0608-04
6.0		8.0	12.0	4.8	1.00	GFM-0608-048
6.0		8.0	12.0	5.0	1.00	GFM-0608-05
6.0	+0.020	8.0	12.0	6.0	1.00	GFM-0608-06
6.0	+0.068	8.0	12.0	7.0	1.00	GFM-0608-07
6.0		8.0	12.0	8.0	1.00	GFM-0608-08
6.0		8.0	12.0	10.0	1.00	GFM-0608-10
6.0		8.0	14.0	12.0	1.00	GFM-060814-12
6.0		8.0	12.0	25.0	1.00	GFM-0608-25
6.0		8.0	12.0	35.0	1.00	GFM-0608-35
7.0		8.0	12.0	1.7	0.50	GFM-0708-017
7.0	+0.013	8.0	12.0	3.0	0.50	GFM-0708-03
7.0	+0.049	8.0	12.0	6.0	0.50	GFM-0708-06
7.0		8.0	12.0	8.0	0.50	GFM-0708-08
7.0		9.0	15.0	3.5	1.00	GFM-0709-035
7.0	+0.025	9.0	15.0	6.0	1.00	GFM-0709-06
7.0	+0.083	9.0	15.0	10.0	1.00	GFM-0709-10
7.0		9.0	19.0	10.0	1.00	GFM-070919-10
7.0		9.0	15.0	12.0	1.00	GFM-0709-12
8.0		9.0	15.0	3.0	0.50	GFM-0809-03
8.0	+0.013	9.0	13.0	3.5	0.50	GFM-0809-035
8.0	+0.049	9.0	13.0	5.5	0.50	GFM-0809-055
8.0		9.0	13.0	8.0	0.50	GFM-0809-08
8.0		9.0	13.0	12.0	0.50	GFM-0809-12

³⁾ 圧入後、試験方法、61ページ

製品概要

d1	d1	d2	d3	b1	b2	製品番号
[mm]	公差 ³⁾	[mm]	[mm]	[mm]	[mm]	
8.0	+0.025	10.0	15.0	3.0	1.00	GFM-0810-03
8.0	+0.083	10.0	18.0	3.0	1.00	GFM-081018-03
8.0		10.0	15.0	4.0	1.00	GFM-0810-04
8.0	+0.040	10.0	14.0	5.0	1.00	GFM-081014-05
8.0	+0.098	10.0	15.0	5.5	1.00	GFM-0810-05
8.0		10.0	14.0	6.0	1.00	GFM-081014-06
8.0		10.0	15.0	6.5	1.00	GFM-0810-065
8.0	+0.025	10.0	15.0	7.5	1.00	GFM-0810-07
8.0	+0.083	10.0	13.0	8.0	1.00	GFM-081013-08
8.0		10.0	14.0	8.0	1.00	GFM-081014-08
8.0		10.0	15.0	9.5	1.00	GFM-0810-09
8.0		10.0	15.0	10.0	1.00	GFM-0810-10
8.0	+0.040	10.0	14.0	10.0	1.00	GFM-081014-10
8.0	+0.098	10.0	14.0	11.0	1.00	GFM-0810-11
8.0		10.0	16.0	11.5	1.50	GFM-081016-11
8.0		10.0	12.0	12.5	1.00	GFM-081012-125
8.0	+0.025	10.0	15.0	15.0	1.00	GFM-0810-15
8.0	+0.083	10.0	16.0	15.0	1.50	GFM-081016-15
8.0		10.0	17.0	15.0	1.00	GFM-081017-15
8.0		10.0	15.0	25.0	1.00	GFM-0810-25
8.0		10.0	15.0	30.0	1.00	GFM-0810-30
8.0	+0.040	12.0	16.0	6.0	2.00	GFM-0812-06
8.0	+0.130	12.0	21.0	8.0	2.00	GFM-081221-08
9.0	+0.013	10.0	15.0	6.5	0.50	GFM-0910-065
9.0	+0.049	10.0	15.0	17.5	0.50	GFM-0910-17
10.0	+0.013	11.0	20.0	3.5	0.50	GFM-1011-03
10.0	+0.046	11.0	20.0	4.4	0.50	GFM-1011-044
10.0	+0.013	11.0	15.0	4.4	0.50	GFM-1011-044
10.0	+0.049	11.0	15.0	10.0	0.50	GFM-1011-10
10.0		12.0	18.0	3.5	1.00	GFM-1012-035
10.0		12.0	18.0	4.0	1.00	GFM-1012-04
10.0		12.0	18.0	5.0	1.00	GFM-1012-05
10.0		12.0	18.0	6.0	1.00	GFM-1012-06
10.0		12.0	16.0	6.0	1.00	GFM-101216-06
10.0		12.0	18.0	7.0	1.00	GFM-1012-07
10.0	+0.025	12.0	18.0	9.0	1.00	GFM-1012-09
10.0	+0.083	12.0	16.0	9.0	1.00	GFM-101216-09
10.0		12.0	18.0	10.0	1.00	GFM-1012-10
10.0		12.0	18.0	12.0	1.00	GFM-1012-12
10.0		12.0	15.0	12.0	1.00	GFM-101215-12
10.0		12.0	18.0	15.0	1.00	GFM-1012-15
10.0		12.0	16.0	15.0	1.00	GFM-101216-15
10.0		12.0	18.0	17.0	1.00	GFM-1012-17
11.0		12.0	16.0	6.0	0.50	GFM-1112-06
12.0	+0.016	13.0	17.0	3.0	0.50	GFM-1213-03
12.0	+0.059	13.0	17.0	12.0	0.50	GFM-1213-12

³⁾ 圧入後、試験方法、61ページ

d1	d1	d2	d3	b1	b2	製品番号
[mm]	公差 ³⁾	[mm]	[mm]	[mm]	[mm]	
12.0	+0.016	13.0	15.0	12.0	0.50	GFM-121315-12
12.0	+0.059	13.0	15.0	12.0	0.50	GFM-121315-12
12.0		14.0	20.0	3.0	1.00	GFM-1214-03
12.0		14.0	18.0	4.0	1.00	GFM-121418-04
12.0		14.0	20.0	5.0	1.00	GFM-1214-05
12.0		14.0	20.0	6.0	1.00	GFM-1214-06
12.0		14.0	20.0	7.0	1.00	GFM-1214-07
12.0		14.0	18.0	8.0	1.00	GFM-121418-08
12.0		14.0	20.0	9.0	1.00	GFM-1214-09
12.0		14.0	20.0	10.0	1.00	GFM-1214-10
12.0		14.0	18.0	10.0	1.00	GFM-121418-10
12.0		14.0	20.0	11.0	1.00	GFM-1214-11
12.0		14.0	20.0	12.0	1.00	GFM-1214-12
12.0		14.0	18.0	12.0	1.00	GFM-121418-12
12.0		14.0	20.0	15.0	1.00	GFM-1214-15
12.0		14.0	18.0	15.0	1.00	GFM-121418-15
12.0		14.0	20.0	17.0	1.00	GFM-1214-17
12.0	+0.032	14.0	20.0	20.0	1.00	GFM-1214-20
12.0	+0.102	14.0	18.0	20.0	1.00	GFM-121418-20
12.0		14.0	20.0	24.0	1.00	GFM-1214-24
12.0		14.0	20.0	31.0	1.00	GFM-1214-31
12.0		14.0	20.0	40.0	1.00	GFM-1214-40
13.0		15.0	22.0	6.0	1.00	GFM-1315-06
13.0		15.0	22.0	8.0	1.00	GFM-1315-08
13.0		15.0	22.0	40.0	1.00	GFM-131522-40
14.0		16.0	22.0	3.0	1.00	GFM-1416-03
14.0		16.0	22.0	4.0	1.00	GFM-1416-04
14.0		16.0	22.0	6.0	1.00	GFM-1416-06
14.0		16.0	22.0	8.0	1.00	GFM-1416-08
14.0		16.0	22.0	10.0	1.00	GFM-1416-10
14.0		16.0	22.0	12.0	1.00	GFM-1416-12
14.0		16.0	22.0	17.0	1.00	GFM-1416-17
14.0		16.0	22.0	21.0	1.00	GFM-1416-21
15.0		16.0	20.0	2.0	0.50	GFM-1516-02
15.0	+0.016	16.0	20.0	2.5	0.50	GFM-1516-025
15.0	+0.059	16.0	20.0	3.0	0.50	GFM-1516-03
15.0		16.0	20.0	15.0	0.50	GFM-1516-15
15.0		17.0	23.0	4.0	1.00	GFM-1517-04
15.0		17.0	23.0	4.5	1.00	GFM-1517-045
15.0		17.0	23.0	5.0	1.00	GFM-1517-05
15.0		17.0	23.0	9.0	1.00	GFM-1517-09
15.0		17.0	23.0	12.0	1.00	GFM-1517-12
15.0	+0.032	17.0	23.0	17.0	1.00	GFM-1517-17
15.0	+0.102	17.0	23.0	20.0	1.00	GFM-1517-20
15.0		18.0	24.0	32.0	1.50	GFM-151824-32
16.0		18.0	24.0	4.0	1.00	GFM-1618-04
16.0		18.0	24.0	5.0	1.00	GFM-1618-05
16.0		18.0	24.0	6.0	1.00	GFM-1618-060

ベアリングテクノロジー | すべり軸受 | イグリデュールG

d1	d1	d2	d3	b1	b2	製品番号	d1	d1	d2	d3	b1	b2	製品番号
[mm]	公差 ³⁾	[mm]	d13 ³⁾	h13	h13		[mm]	公差 ³⁾	[mm]	[mm]	[mm]	[mm]	
16.0		18.0	24.0	9.0	1.00	GFM-1618-09	28.0		30.0	36.0	31.0	1.00	GFM-283036-31
16.0		18.0	24.0	12.0	1.00	GFM-1618-12	28.0		30.0	35.0	36.0	1.00	GFM-2830-36
16.0		18.0	24.0	16.0	1.00	GFM-1618-16	28.0		30.0	35.0	48.0	1.00	GFM-2830-48
16.0		18.0	24.0	17.0	1.00	GFM-1618-17	28.0		32.0	39.0	20.0	2.00	GFM-283239-20
16.0		18.0	24.0	21.0	1.00	GFM-1618-21	28.0		32.0	50.0	35.0	2.00	GFM-283250-35
17.0		19.0	25.0	9.0	1.00	GFM-1719-09	30.0		31.0	36.0	20.0	0.50	GFM-3031-20
17.0		19.0	25.0	16.0	1.00	GFM-1719-16	30.0		31.0	35.0	30.0	0.50	GFM-3031-30
17.0		19.0	25.0	25.0	1.00	GFM-1719-25	30.0		32.0	37.0	4.0	1.00	GFM-3032-04
18.0	+0,032	20.0	26.0	4.0	1.00	GFM-1820-04	30.0	+0,040	32.0	37.0	12.0	1.00	GFM-3032-12
18.0	+0,102	20.0	26.0	6.0	1.00	GFM-1820-06	30.0	+0,124	32.0	37.0	17.5	1.00	GFM-3032-17
18.0		20.0	22.0	6.0	1.00	GFM-182022-06	30.0		32.0	37.0	22.0	1.00	GFM-3032-22
18.0		20.0	26.0	9.0	1.00	GFM-1820-09	30.0		34.0	42.0	9.0	2.00	GFM-3034-09
18.0		20.0	26.0	11.0	1.00	GFM-1820-11	30.0		34.0	40.0	10.0	2.00	GFM-303440-10
18.0		20.0	26.0	12.0	1.00	GFM-1820-12	30.0		34.0	42.0	16.0	2.00	GFM-3034-16
18.0		20.0	26.0	17.0	1.00	GFM-1820-17	30.0		34.0	42.0	20.0	2.00	GFM-3034-20
18.0		20.0	26.0	22.0	1.00	GFM-1820-22	30.0		34.0	42.0	26.0	2.00	GFM-3034-26
18.0		20.0	26.0	30.0	1.00	GFM-1820-30	30.0		34.0	42.0	37.0	2.00	GFM-3034-37
18.0		20.0	26.0	32.0	1.00	GFM-1820-32	32.0		36.0	40.0	16.0	2.00	GFM-3236-16
18.0		22.0	26.0	28.0	2.00	GFM-1822-28	32.0		36.0	40.0	26.0	2.00	GFM-3236-26
20.0	+0,020	21.0	26.0	3.5	0.50	GFM-2021-035	34.0		38.0	50.0	35.0	2.00	GFM-343850-35
20.0	+0,072	21.0	25.0	15.0	0.50	GFM-2021-15	35.0		39.0	47.0	5.8	2.00	GFM-3539-058
20.0		21.0	25.0	20.0	0.50	GFM-2021-20	35.0		39.0	47.0	7.0	2.00	GFM-3539-07
20.0		23.0	30.0	7.0	1.50	GFM-2023-07	35.0		39.0	47.0	12.0	2.00	GFM-3539-12
20.0		23.0	26.0	7.0	1.50	GFM-202326-07	35.0		39.0	47.0	16.0	2.00	GFM-3539-16
20.0		23.0	30.0	11.5	1.50	GFM-2023-11	35.0		39.0	47.0	26.0	2.00	GFM-3539-26
20.0		23.0	28.0	15.0	1.50	GFM-202328-15	35.0		39.0	47.0	36.0	2.00	GFM-3539-36
20.0		23.0	30.0	16.5	1.50	GFM-2023-16	38.0		42.0	54.0	10.0	2.00	GFM-3842-10
20.0		23.0	29.0	20.0	1.50	GFM-202329-20	38.0		42.0	54.0	22.0	2.00	GFM-3842-22
20.0	+0,040	23.0	30.0	21.5	1.50	GFM-2023-21	40.0		44.0	52.0	7.0	2.00	GFM-4044-07
20.0	+0,124	23.0	26.0	21.5	1.50	GFM-202326-21	40.0	+0,050	44.0	52.0	14.0	2.00	GFM-4044-14
22.0		24.0	30.0	25.0	1.00	GFM-2224-25	40.0	+0,150	44.0	52.0	20.0	2.00	GFM-4044-20
22.0		25.0	29.0	4.5	1.50	GFM-222529-045	40.0		44.0	52.0	30.0	2.00	GFM-4044-30
22.0		25.0	30.0	21.5	1.50	GFM-222530-215	40.0		44.0	52.0	40.0	2.00	GFM-4044-40
22.0		25.0	30.0	25.0	1.50	GFM-222530-25	40.0		44.0	52.0	50.0	2.00	GFM-4044-50
22.0		25.0	35.0	31.5	1.50	GFM-222535-315	40.0		46.0	50.0	20.0	2.00	GFM-4046-20
24.0		27.0	32.0	7.0	1.50	GFM-2427-07	42.0		46.0	53.0	19.0	2.00	GFM-4246-19
24.0		27.0	32.0	10.5	1.50	GFM-2427-10	45.0		50.0	58.0	25.0	2.00	GFM-4550-25
25.0	+0,020	26.0	30.0	25.0	0.50	GFM-2526-25	45.0		50.0	58.0	30.0	2.00	GFM-4550-30
25.0	+0,072	27.0	32.0	7.0	1.00	GFM-2527-07	45.0		50.0	58.0	50.0	2.00	GFM-4550-50
25.0		27.0	32.0	48.0	1.00	GFM-2527-48	50.0		55.0	63.0	7.0	2.00	GFM-5055-07
25.0		28.0	30.0	10.0	1.50	GFM-252830-10	50.0		55.0	63.0	10.0	2.00	GFM-5055-10
25.0		28.0	30.0	10.0	1.50	GFM-252830-10	50.0		55.0	63.0	25.0	2.00	GFM-5055-25
25.0	+0,040	28.0	35.0	11.5	1.50	GFM-2528-11	50.0		55.0	63.0	40.0	2.00	GFM-5055-40
25.0	+0,124	28.0	35.0	16.5	1.50	GFM-2528-16	50.0		55.0	63.0	50.0	2.00	GFM-5055-50
25.0		28.0	35.0	21.5	1.50	GFM-2528-21	60.0		65.0	73.0	7.0	2.00	GFM-6065-07
26.0		30.0	37.0	12.0	2.00	GFM-2630-12	60.0	+0,060	65.0	73.0	22.0	2.00	GFM-6065-22
27.0		30.0	38.0	20.0	1.50	GFM-2730-20	60.0	+0,180	65.0	73.0	30.0	2.00	GFM-6065-30
28.0		30.0	35.0	10.0	1.00	GFM-2830-10	60.0		65.0	73.0	50.0	2.00	GFM-6065-50

³⁾ 圧入後、試験方法、61ページ

製品概要

d1	d1	d2	d3	b1	b2	製品番号	d1	d1	d2	d3	b1	b2	製品番号
[mm]	公差 ³⁾	[mm]	[mm]	[mm]	[mm]		[mm]	公差 ³⁾	[mm]	[mm]	[mm]	[mm]	
60.0		65.0	80.0	62.0	2.00	GFM-606580-62	100.0		105.0	113.0	100.0	2.50	GFM-100105-100
65.0		70.0	78.0	50.0	2.00	GFM-6570-50	110.0	+0,072	115.0	123.0	100.0	2.50	GFM-110115-100
70.0		75.0	83.0	50.0	2.00	GFM-7075-50	120.0	+0,212	125.0	133.0	80.0	2.50	GFM-120125-80
70.0	+0,060	75.0	83.0	85.5	2.00	GFM-7075-855	120.0		125.0	133.0	100.0	2.50	GFM-120125-100
75.0	+0,180	80.0	88.0	50.0	2.00	GFM-7580-50	125.0		130.0	138.0	100.0	2.50	GFM-125130-100
80.0		85.0	93.0	50.0	2.50	GFM-8085-50	130.0	+0,085	135.0	143.0	100.0	2.50	GFM-130135-100
80.0		85.0	93.0	100.0	2.50	GFM-8085-100	140.0	+0,245	145.0	153.0	100.0	2.50	GFM-140145-100
85.0		90.0	98.0	100.0	2.50	GFM-8590-100	150.0		155.0	163.0	40.0	2.50	GFM-150155-40
90.0	+0,072	95.0	103.0	100.0	2.50	GFM-9095-100	150.0		155.0	163.0	100.0	2.50	GFM-150155-100
95.0	+0,212	100.0	108.0	100.0	2.50	GFM-95100-100	195.0	+0,100	205.0	240.0	65.0	5.00	GFM-195205240-65
100.0		105.0	113.0	42.5	2.50	GFM-100105-425		+0,285					

³⁾ 圧入後、試験方法、61ページ

 在庫から入手可能
納期は、オンラインで確認ください
www.igus.co.jp/24

 オンライン注文
納期、価格、オンラインツールを含む
www.igus.co.jp/G

 発注書
当社の価格は注文数に応じて変動します。
現在の価格はオンラインでご確認いただけます。

最少注文金額なし
小口注文による追加料金なし