

Model: HT-600 400X600mm

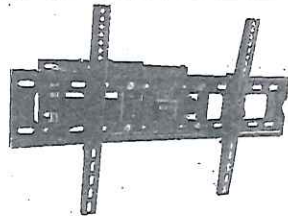

- | | | | |
|------------------------------|--|---|---|
| A x 12pcs
6x50
 | B x 14pcs
5x20
6x20
8x20
5x35
 | C x 12pcs
Ø6
Ø8
Ø8x10
 | D x 5pcs
x2pcs
6x12x2pcs
 |
|------------------------------|--|---|---|

TOOLS NEEDED

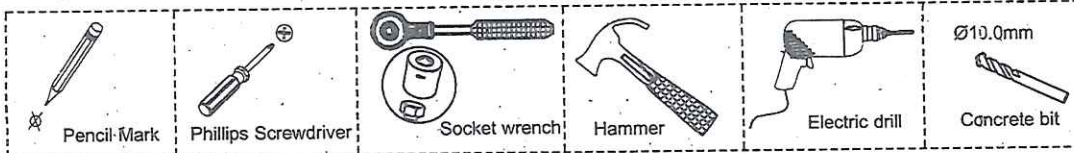

Step-1:

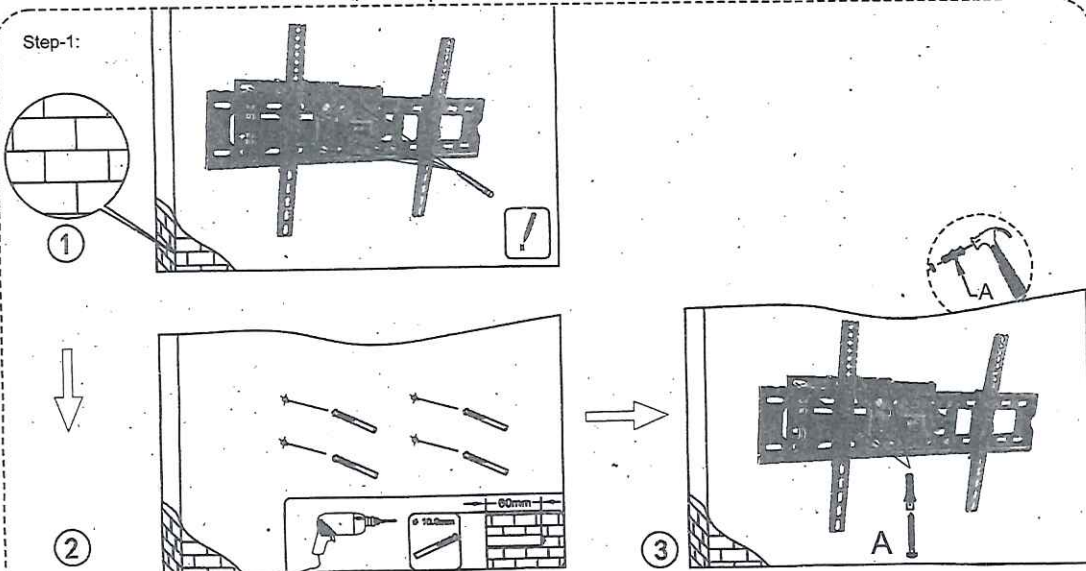

Step-2:

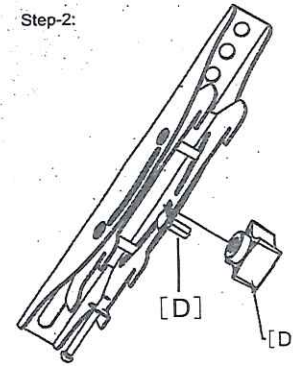

The knob into the right / left bracket.

Step-3:

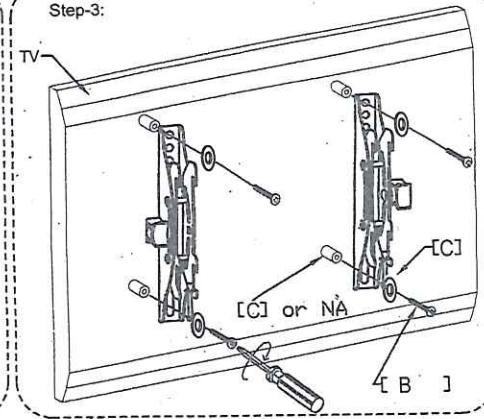

Step-4:

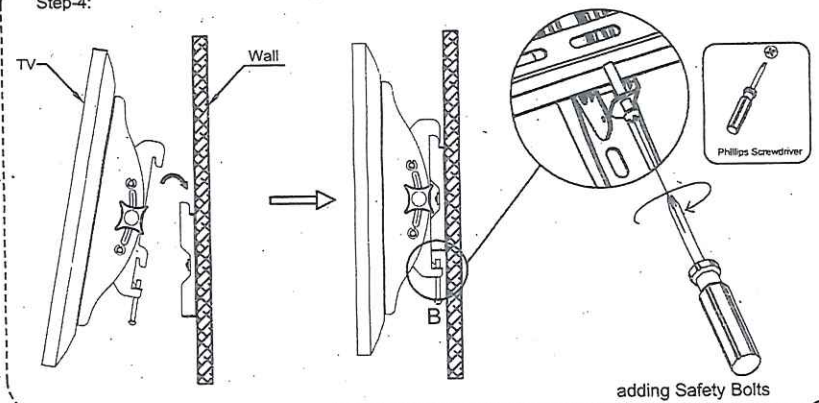

adding Safety Bolts



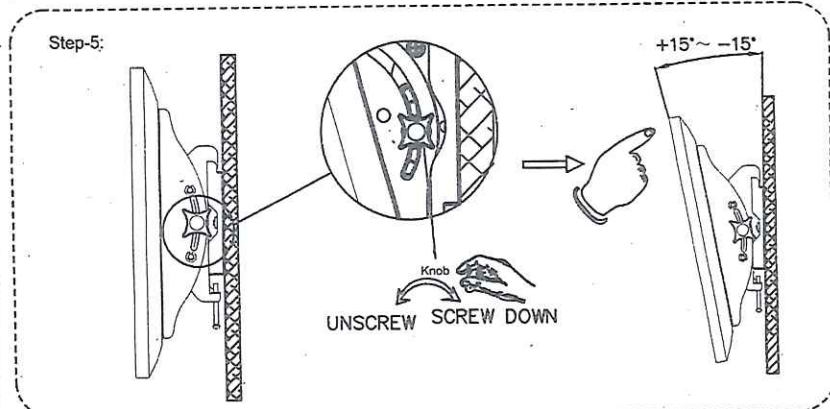



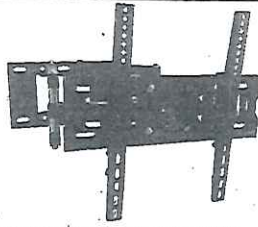

Step-5:



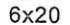
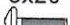
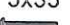





UNSCREW SCREW DOWN

Model: HT-400 400X400mm

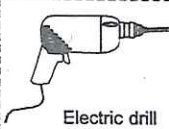

- | | | | |
|---|--|---|--|
| A x 12pcs
6x50

10x50
 | B x 14pcs
5x20

6x20

8x20

5x35
 | C x 12pcs
 Ø6
 Ø8
 Ø8x10 | D x5pcs
 x2pcs
 6x12x2pcs

Horizontal instrument |
|---|--|---|--|

TOOLS NEEDED

- | | | | | | |
|---|--|---|--|---|---|
|  Pencil-Mark |  Phillips Screwdriver |  Socket wrench |  Hammer |  Electric drill |  Ø10.0mm
Concrete bit |
|---|--|---|--|---|---|

